

Closed Wedge Socket CWS

Product information



Intended for attaching of wire rope where switching often occur, e.g. blocks of mobilecranes, or to be able to adjust the length of the wire rope. See recommended assembly to get correct results. The wedge socket is delivered complete.

Marking house and wedge: Wire \varnothing mm.

[... Read more](#)

Material: Cast alloy steel with high mechanical properties.

Temperature range: - 40°C to + 110°C - Use at higher temperatures possible with reduction of WLL.

Finish: Blue painted (P) or hot dip galvanized (G).

Note: The efficiency of a 6 and 8 strand wire rope/wedge socket connection is 80% of the minimum breaking load of the wire but limited to the minimum breaking load of the socket (MBL).

Closed Wedge Socket CWS

Blueprint

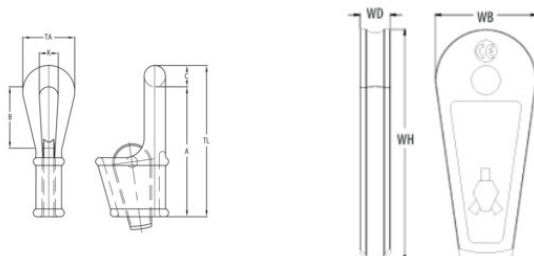

Technical data

Part code	Code	Rope Ø range mm	MBL ton	Finish	A mm	B mm	C mm	K mm	TA mm	TLmm mm	WH mm	WB mm	WD mm	Weight kg
121502600172	CWS 305	24-26	75	Galvanized	290	130	50	55	125	340	212	83	28	14