

## Clevis self-locking Hook Pewag KLHWP

---

### Product information



KLHWP Clevis safety hook closes and locks automatically under load.

... [Read more](#)

**Material:** Alloy steel.

**Marking:** According to standard, CE-marked, Pewag or PW, winner pro or 12, H16, batch code and type.

**Temperature range:** -60°C up to +300°C.

**Finish:** Light blue powdercoated.

**Standard:** EN 1677-3

**Warning:** Not to be heat-treated.

**Safety factor:** 4:1

**Grade:** 12

## Clevis self-locking Hook Pewag KLHWP

### Blueprint

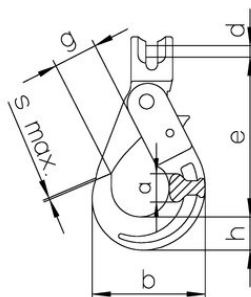

### Technical data

| Part code    | Code     | WLL ton | EWL | a mm | b mm mm | d mm mm | e mm mm | g mm mm | h mm mm | s max. mm mm | Weight kg |
|--------------|----------|---------|-----|------|---------|---------|---------|---------|---------|--------------|-----------|
| 403300240090 | KLHWP 7  | 2.36    | 116 | 23.6 | 90      | 9.5     | 116     | 32      | 24,5    | 1            | 0.89      |
| 403300300090 | KLHWP 8  | 3       | 115 | 23.6 | 90      | 10.7    | 115     | 32      | 24,5    | 1            | 0.9       |
| 403300500090 | KLHWP 10 | 5       | 136 | 27.8 | 113     | 14      | 136     | 45      | 31,5    | 1            | 1.6       |
| 403300800090 | KLHWP 13 | 8       | 179 | 33.7 | 146     | 17.5    | 179     | 54      | 39,8    | 1.5          | 3.42      |