

## Former with Thread Pin and Wing Nut Starcon

### Product information

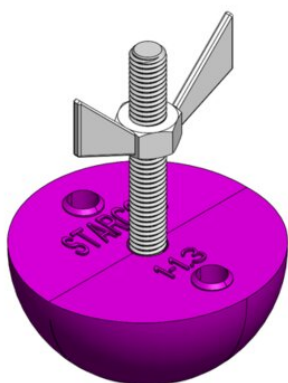

Starcon former with Starcon threaded pin and Starcon wing nut are used where it is necessary to attach the molds to the mold before concrete, placed around the element. The former are semi-circular and designed to hold the anchor in place in the mold. After casting the concrete element, the Starcon former can be removed from the head of the anchor, giving free access for the Starcon lifting eye to grab the anchor head and ensure a safe lift. The former are made of plastic and can be used several times, if they are cleaned of concrete residue with water after each use.

**Applications:** The former are used to ensure that the spherical anchor head is not covered by concrete during pouring.

**Advantages:** Quick coupling and disconnection of the spherical anchor. Load capacities from 1.3S to 20S with durable, specially treated steel anchors for high reliability.

Can be recycled.

**Load group:** 1.3t – 20t

**Technical information:** CE marking in accordance with MD 2006/42 FC [... Read more](#)

**Marking:** Load group + S(Starcon)

**Finish:** Colour coded by load group

**Note:** The delivery time for the individual products is estimated and if the desired quantity is not in stock, please contact [CERTEX Danmark A/S – Starcon](#) for information on the applicable delivery time.

## Former with Thread Pin and Wing Nut Starcon

### Blueprint



### Technical data

Part code	Load grp. t	Colour	D mm	H, mm	Packing Qty.
650311013001	1.0-1.3	Violet	60	30	1
650311025001	1.5-2.5	Green	74	36	1
650311050001	3.0-5.0	Red	94	46	1
650311075001	6.0-7.5	Orange	118	58	1
650311100001	8.0-10.0	Orange	118	58	1
650311150001	12.0-15.0	Blue	160	78	1
650311200001	16.0-20.0	Blue	160	78	1