

Web Connector Crosby S-280

Product information



Crosby S-280 Web Connector is designed to connect synthetic web and round sling to eye hook, masterlinks or rings and standard shackles.

... [Read more](#)

Material: All alloy construction.

Marking: CE-marked

Finish: Red painted.

Web Connector Crosby S-280

Blueprint

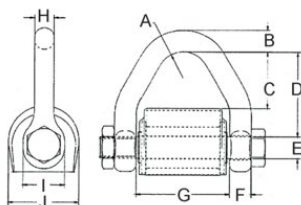

Technical data

Part code	WLL ton	Webbing width mm	Eye width mm	Webbing width in	A mm	B mm	C mm	D mm	E mm	F mm	G, mm	H, mm	I mm mm	J mm	Weight kg
40981021681	2.95	50	50	2	19.1	15.7	41.4	62	16	15.7	68.5	14.2	30.2	51.5	0.68
40981021690	4.08	35	75	3	19.1	17.5	27.9	51	19.1	17.5	55.5	15.2	35.1	59.5	0.86
40981021700	5.67	50	100	4	19.1	20.6	42.2	65	22.4	19.1	68.5	17.5	41.1	62.5	1.32
40981021709	7.7	75	150	6	25.4	23.9	62.5	89	25.4	22.4	93.5	22.4	47.8	72	2.31