

Bolt type Sling Shackle Crosby S-252

Product information



The Crosby S-252 Bolt type Sling Shackle is designed to connect slings to steel fittings. Increased radius of bow gives wider sling bearing surface resulting in an increased area for load distribution, thus: Increasing Synthetic Sling efficiency as compared to standard anchor and chain shackle bows and conventional hooks. This allows 100% of the slings rated Working Load Limit to be achieved.

Allows better load distribution on internal fibers.

Standard: Meets or exceeds all requirements of ASME B30.26 including identification, ductility, design factor, proof load and temperature requirements. Importantly, these shackles meet other critical performance requirements including fatigue life, impact properties and material traceability, not addressed by ASME B30.26.

[... Read more](#)

Material: Alloy steel.

Marking: CE-marked, WLL, traceability code.

Safety factor: 5:1

Bolt type Sling Shackle Crosby S-252

Blueprint

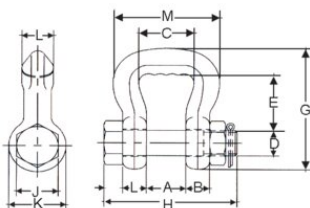

Technical data

Part code	WLL ton	EWL mm	Eye width mm	A mm	B mm	C mm	D mm	E mm	F mm	G mm	H mm	J mm	K mm	L mm	M mm	Weight kg
420100330220	3.25	19.1	25	26.9	14.7	35.1	19.1	38.1	11.2	86	93.5	28.4	38.1	19.1	68.5	0.64
420100650220	6.5	25.4	35	31.8	19.1	44.5	22.4	47.8	12.7	105	108	33.3	46	25.4	86	1.09
420100880220	8.75	28.4	50	35.1	22.4	57	25.4	71.5	14.2	140	120	38.1	53.1	28.4	106	1.86
420101250220	12.5	35.1	75	41.1	28.4	82.5	31.8	77.5	19.1	161	149	47.8	66.5	35.1	143	3.63
420102050220	20.5	44.5	100	54	35.1	114	38.1	133	22.4	240	183	57	79	44.5	191	7.67
420103500220	35	57.2	125	63.5	44.5	140	51	161	28.4	292	236	76	106	57.2	233	15.9
420105000220	50	69.9	150	76	54	165	57	196	31.8	349	264	86	121	69.9	279	26.1