

Starcon Double Headed Spherical Anchor

Product information

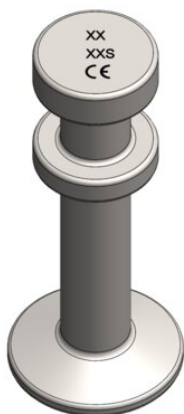

The Starcon double headed spherical anchor is designed for concrete pouring with a sturdy foot for secure anchoring and a cylindrical head that easily connects with a Starcon lifting eye. It is ideal for applications where the recess moulder remains attached to the reinforcement, such as face-up floor and deck elements, overhead supply pipes and stair installations.

The anchor is also suitable for concrete products that are to be repeatedly produced in the same design and where semi-automatic anchor machines are used for assembly in the mould. This makes it timesaving to insert the anchor into either the mounted form or into the semi-automatic anchor machine.

Areas of application: Concrete pipes, wells, stairs, pipes and columns

Advantages: Ideal for applications where the recess mould remains attached to the reinforcement.

Quick connection/disconnection with shapes and lifting eyes, perfect for efficient transport and setup.

Load group: 1.3t – 5t

Technical information: CE marking according to MD 2006/42 EF

Starcon product is designed according to EN13155-2009 and follows the guidelines of VDI/BV-BS 6205 and DS/CEN/TR 15728.

EPD: Our Environmental Product Declarations (EPDs) are available in the LCA NO calculator/software. These EPDs have been prepared in strict accordance with ISO 14025 and EN 15804 standards.

Download the EPDs from the LCA database:

Untreated Products: [Starcon Lifting and Handling Systems for Concrete elements - Untreated - EPD Norge](#)

Surface treated Products: [Starcon Lifting and Handling Systems for Concrete elements - Surface Treated. - EPD Norge](#)

... [Read more](#)

Marking: CE-marked, batch code, load group + S(Starcon)

Finish: Untreated - Corrosion class C1 - ISO 12944-2. Hot-dip galvanized - Corrosion class C3 - ISO 12944-2

Note: The delivery time for the individual products is estimated and if the desired quantity is not in stock, please contact [CERTEX Danmark A/S – Starcon](#) for information on the applicable delivery time.

Starcon Double Headed Spherical Anchor

Blueprint

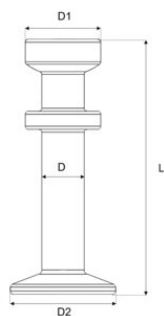

Starcon Double Headed Spherical Anchor

Technical data

Part code	Load grp. t	Length mm	Finish	L mm	D mm	D1 mm	D2mm mm	Weight kg	Packing Qty.
65011101300402	1.3	40	Hot dip galvanized	40	10	19	25	0.06	250
65011101300452	1.3	45	Hot dip galvanized	45	10	19	25	0.06	250
65011101300651	1.3	65	Untreated	65	10	19	25	0.07	225
65011101300652	1.3	65	Hot dip galvanized	65	10	19	25	0.07	225
65011101300852	1.3	85	Hot dip galvanized	85	10	19	25	0.09	175
65011101301201	1.3	120	Untreated	120	10	19	25	0.11	130
65011101301202	1.3	120	Hot dip galvanized	120	10	19	25	0.11	130
65011102500452	2.5	45	Hot dip galvanized	45	14	26	35	0.12	140
65011102500552	2.5	55	Hot dip galvanized	55	14	26	35	0.13	120
65011102500682	2.5	68	Hot dip galvanized	68	14	26	35	0.15	100
65011102500851	2.5	85	Untreated	85	14	26	35	0.18	90
65011102500852	2.5	85	Hot dip galvanized	85	14	26	35	0.18	90
65011102501201	2.5	120	Untreated	120	14	26	35	0.22	70
65011102501202	2.5	120	Hot dip galvanized	120	14	26	35	0.22	70
65011102501701	2.5	170	Untreated	170	14	26	35	0.27	50
65011102501702	2.5	170	Hot dip galvanized	170	14	26	35	0.27	50
65011105000752	5	75	Hot dip galvanized	75	20	36	50	0.35	40
65011105000952	5	95	Hot dip galvanized	95	20	36	50	0.4	30
65011105001102	5	110	Hot dip galvanized	110	20	36	50	0.44	30
65011105001101	5	110	Untreated	110	20	36	50	0.44	30
65011105001202	5	120	Hot dip galvanized	120	20	36	50	0.46	30
65011005001401	5	140	Untreated	140	20	36	50	0.5	30
65011105002401	5	240	Untreated	240	20	36	50	0.78	20
65011105002402	5	240	Hot dip galvanized	240	20	36	50	0.78	20