

## Spherical Anchor Starcon

### Product information

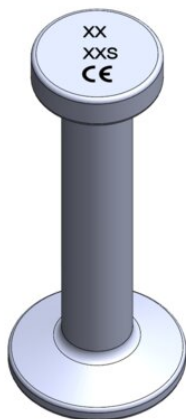

Starcon spherical anchor is a steel component designed for embedding in concrete. It has a specially designed base that ensures solid anchoring in hardened concrete. By using a longer anchor, a larger area of anchoring is activated, effectively distributing the load.

The cylindrical anchor head connects to a Starcon lifting eye in seconds, enabling efficient lifting operations. The anchor is ideal for almost all types of concrete element projects that require an efficient and reliable lifting solution.

**Areas of application:** Columns, beams, decks/floor, walls and pipes

**Advantages:** Wide range of spherical anchors for all types and sizes of prefabricated elements, providing cost-effective lifting solutions.

Quick connection and disconnection with shapes and lifting eyes, perfect for efficient transport and set-up with minimal handling time.

**Load group:** 1.3t – 20t

**Technical information:** CE marking according to MD 2006/42 EF

Starcon product is designed according to EN13155-2009 and follows the guidelines of VDI/BV-BS 6205 and DS/CEN/TR 15728.

**EPD:** Our Environmental Product Declarations (EPDs) are available in the LCA NO calculator/software. These EPDs have been prepared in strict accordance with ISO 14025 and EN 15804 standards.

**Download the EPDs from the LCA database:**

Untreated Products: [Starcon Lifting and Handling Systems for Concrete elements - Untreated - EPD Norge](#)

Surface treated Products: [Starcon Lifting and Handling Systems for Concrete elements - Surface Treated. - EPD Norge](#)

... [Read more](#)

**Marking:** CE-marked, batch code, load group + S(Starcon)

**Finish:** Untreated - Corrosion class C1 - ISO 12944-2. Hot-dip galvanized - Corrosion class C3 - ISO 12944-2. Stainless steel - Corrosion class C5 - ISO 12944-2

**Note:** The delivery time of the individual products is estimated and if the desired quantity is not in stock, please contact [CERTEX Danmark A/S – Starcon](#) to get information about the applicable delivery time.

## Spherical Anchor Starcon

### Blueprint

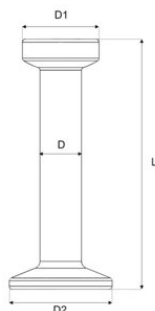

### Technical data

Part code	Load grp. t	Length mm	Finish	D mm	D1 mm	D2mm mm	L mm	Weight kg	Packing Qty.
65011001300401	1.3	40	Untreated	10	19	25	40	0.05	300
65011001300402	1.3	40	Hot dip galvanized	10	19	25	40	0.05	300
65011001300551	1.3	55	Untreated	10	19	25	55	0.06	250
65011001300552	1.3	55	Hot dip galvanized	10	19	25	55	0.06	250
65011001300651	1.3	65	Untreated	10	19	25	65	0.07	250
65011001300652	1.3	65	Hot dip galvanized	10	19	25	65	0.07	250
65011001300851	1.3	85	Untreated	10	19	25	85	0.08	200
65011001300852	1.3	85	Hot dip galvanized	10	19	25	85	0.08	200
65011001301201	1.3	120	Untreated	10	19	25	120	0.1	150
65011001301202	1.3	120	Hot dip galvanized	10	19	25	120	0.1	150
65011002500451	2.5	45	Untreated	14	26	35	45	0.12	140
65011002500452	2.5	45	Hot dip galvanized	14	26	35	45	0.12	140
65011002500551	2.5	55	Untreated	14	26	35	55	0.13	120
65011002500552	2.5	55	Hot dip galvanized	14	26	35	55	0.13	120
65011002500681	2.5	68	Untreated	14	26	35	68	0.15	100
65011002500682	2.5	68	Hot dip galvanized	14	26	35	68	0.15	100
65011001302402	1.3	240	Hot dip galvanized	10	19	25	240	0.17	90
65011002500851	2.5	85	Untreated	14	26	35	85	0.17	100
65011002500852	2.5	85	Hot dip galvanized	14	26	35	85	0.17	100
65011002501202	2.5	120	Hot dip galvanized	14	26	35	120	0.21	75
65011002501201	2.5	120	Untreated	14	26	35	120	0.21	75
65011002501401	2.5	140	Untreated	14	26	35	140	0.23	70

## Spherical Anchor Starcon

### Technical data

Part code	Load grp. t	Length mm	Finish	D mm	D1 mm	D2mm mm	L mm	Weight kg	Packing Qty.
65011002501402	2.5	140	Hot dip galvanized	14	26	35	140	0.23	70
65011002501701	2.5	170	Untreated	14	26	35	170	0.27	60
65011002501702	2.5	170	Hot dip galvanized	14	26	35	170	0.27	60
65011005000651	5	65	Untreated	20	36	50	65	0.32	50
65011005000652	5	65	Hot dip galvanized	20	36	50	65	0.32	50
65011005000751	5	75	Untreated	20	36	50	75	0.34	75
65011005000752	5	75	Hot dip galvanized	20	36	50	75	0.34	75
65011005000851	5	85	Untreated	20	36	50	85	0.36	85
65011005000852	5	85	Hot dip galvanized	20	36	50	85	0.36	85
65011002502801	2.5	280	Untreated	14	26	35	280	0.4	40
65011002502802	2.5	280	Hot dip galvanized	14	26	35	280	0.4	40
65011005000951	5	95	Untreated	20	36	50	95	0.4	40
65011005000952	5	95	Hot dip galvanized	20	36	50	95	0.4	40
65011005001102	5	110	Hot dip galvanized	20	36	50	110	0.43	35
65011005001101	5	110	Untreated	20	36	50	110	0.43	35
65011005001201	5	120	Untreated	20	36	50	120	0.46	35
65011005001202	5	120	Hot dip galvanized	20	36	50	120	0.46	35
65011005001401	5	140	Untreated	20	36	50	140	0.49	30
65011005001402	5	140	Hot dip galvanized	20	36	50	140	0.49	30
65011005001601	5	160	Untreated	20	36	50	160	0.56	30
65011005001602	5	160	Hot dip galvanized	20	36	50	160	0.56	30
65011005001801	5	180	Untreated	20	36	50	180	0.61	25
65011005001802	5	180	Hot dip galvanized	20	36	50	180	0.61	25
65011007500851	7.5	85	Untreated	24	47	60	120	0.62	25
65011005002101	5	210	Untreated	20	36	50	210	0.69	20
65011005002102	5	210	Hot dip galvanized	20	36	50	210	0.69	20
65011007501201	7.5	120	Untreated	24	47	60	120	0.73	20
65011007501202	7.5	120	Hot dip galvanized	24	47	60	120	0.73	20
65011005002401	5	240	Untreated	20	36	50	240	0.76	20
65011005002402	5	240	Hot dip galvanized	20	36	50	240	0.76	20
65011007501401	7.5	140	Untreated	24	47	60	140	0.81	18

## Spherical Anchor Starcon

### Technical data

Part code	Load grp. t	Length mm	Finish	D mm	D1 mm	D2mm mm	L mm	Weight kg	Packing Qty.
65011007501402	7.5	140	Hot dip galvanized	24	47	60	140	0.81	18
65011007501651	7.5	165	Untreated	24	47	60	165	0.89	15
65011007501652	7.5	165	Hot dip galvanized	24	47	60	165	0.89	15
65011010001151	10	115	Untreated	28	47	70	115	0.92	15
65011010001152	10	115	Hot dip galvanized	28	47	70	115	0.92	15
65011010001201	10	120	Untreated	28	47	70	120	0.95	15
65011010001202	10	120	Hot dip galvanized	28	47	70	120	0.96	15
65011010001351	10	135	Untreated	28	47	70	135	0.99	15
65011005003401	5	340	Untreated	20	36	50	340	1.01	15
65011005003402	5	340	Hot dip galvanized	20	36	50	340	1.01	15
65011007502001	7.5	200	Untreated	24	47	60	200	1.01	15
65011007502002	7.5	200	Hot dip galvanized	24	47	60	200	1.01	15
65011010001352	10	135	Hot dip galvanized	28	47	70	135	1.01	15
65011010001501	10	150	Untreated	28	47	70	150	1.09	13
65011010001502	10	150	Hot dip galvanized	28	47	70	150	1.09	13
65011010001701	10	170	Untreated	28	47	70	170	1.18	13
65011010001702	10	170	Hot dip galvanized	28	47	70	170	1.18	13
65011005004801	5	480	Untreated	20	36	50	480	1.36	10
65011005004802	5	480	Hot dip galvanized	20	36	50	480	1.36	10
65011007503002	7.5	300	Hot dip galvanized	24	47	60	300	1.36	10
65011007503001	7.5	300	Untreated	24	47	60	300	1.36	10
65011010002201	10	220	Untreated	28	47	70	220	1.44	10
65011010002202	10	220	Hot dip galvanized	28	47	70	220	1.44	10
65011010002501	10	250	Untreated	28	47	70	250	1.56	10
65011010002502	10	250	Hot dip galvanized	28	47	70	250	1.56	10
65011015001651	15	165	Untreated	34	69	85	165	1.97	8
65011015001652	15	165	Hot dip galvanized	34	69	85	165	1.97	8
65011010003402	10	340	Hot dip galvanized	28	47	70	340	1.98	8
65011010003401	10	340	Untreated	28	47	70	340	1.98	8
65011015002001	15	200	Untreated	34	69	85	200	2.21	7
65011015002002	15	200	Hot dip galvanized	34	69	85	200	2.21	7

## Spherical Anchor Starcon

### Technical data

Part code	Load grp. t	Length mm	Finish	D mm	D1 mm	D2mm mm	L mm	Weight kg	Packing Qty.
65011007505401	7.5	540	Untreated	24	47	60	540	2.24	1
65011007505402	7.5	540	Hot dip galvanized	24	47	60	540	2.24	1
65011015003001	15	300	Untreated	34	69	85	300	2.91	5
65011015003002	15	300	Hot dip galvanized	34	69	85	300	2.91	5
65011020002501	20	250	Untreated	39	70	98	250	3.3	4
65011020002502	20	250	Hot dip galvanized	39	70	98	250	3.3	4
65011010006801	10	680	Untreated	28	47	70	680	3.57	1
65011010006802	10	680	Hot dip galvanized	28	47	70	680	3.57	1
65011015004001	15	400	Untreated	34	69	85	400	3.59	4
65011015004002	15	400	Hot dip galvanized	34	69	85	400	3.59	4
65011020003401	20	340	Untreated	39	70	98	340	4.38	3
65011020003402	20	340	Hot dip galvanized	39	70	98	340	4.38	3
65011020005001	20	500	Untreated	39	70	98	500	5.87	1
65011020005002	20	500	Hot dip galvanized	39	70	98	500	5.87	1
65011020010001	20	1,000	Untreated	39	70	98	1,000	11.75	1
65011020010002	20	1,000	Hot dip galvanized	39	70	98	1,000	11.75	1