

“D” CE Shackle with Safety Pin

Product information

The “D” CE shackle is made from acid-proof stainless steel. With a safety pin. Tested to withstand the most demanding environments.

... [Read more](#)



Material: Stainless steel AISI 316/1.4404

Marking: According to standard

Finish: High polished

Standard: EN 13889

Safety factor: 6:1

“D” CE Shackle with Safety Pin

Blueprint

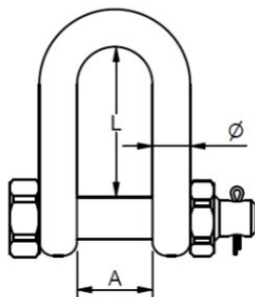

Technical data

Part code	WLL ton	Thread mm	Ø mm mm	A mm	L mm	Weight kg
420100042940	0.35	M6	6	12	19	0.024
420100062940	0.6	M8	8	16	30	0.06
420100092940	0.9	M10	10	20	33	0.11
420100102940	1	M12	11	24	40	0.2
420100132940	1.3	M12	12	28	45	0.31
420100202940	2	M16	14	32	65	0.52
420100282940	2.8	M20	16	35	70	0.76
420100332940	3.3	M22	19	38	76	1.18
420100452940	4.5	M24	22	44	88	1.75
420100502940	5	M27	25	50	100	2.6