

Wire Pulley Sheave, type BR

Product information



Pulley sheaves for rope deflection with plain bearing, with honed steel axle. Grooved profile turned to DIN 15061.

... [Read more](#)

Material: Sheave: S355J2. Mounting plate: gray cast iron GG20.

Finish: Wire rope sheave: galvanized, mounting plate: painted.

Note: Also available with ball-bearing, for higher load.

Wire Pulley Sheave, type BR

Blueprint

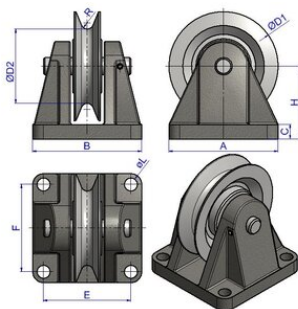

Technical data

Part code	Rope Ø range mm	Type	Max. load ton	D1 mm	D2mm mm	Rmm mm	A x B mm	C mm	E x F mm	H, mm	øL mm	Weight kg
140100600130	2-6	BR 050 G	0.3	50	38	3,2	67 x 67	7	50 X 50	35	7	0.6
140100800130	3-8	BR 075 G	0.6	75	59	4,2	75 x 75	10	60 X 60	50	9	1.4
140100900130	4-9	BR 100 G	0.9	100	80	4,8	90 x 90	10	70 X 70	65	12	2.5
140101000130	6-10	BR 125 G	1.1	125	103	5,3	92 x 92	10	70 X 70	75	12	3.2
140101200130	8-12	BR 150 G	1.25	150	126	6,5	12 x 100	12	75 X 90	90	14	4.8