

## Wire Rope Sheave, type SR

---

### Product information



Wire rope sheave in maintenance-free design for manual and power operation. With plain bushing. Grooved profile turned to DIN 15061.

... [Read more](#)

---

**Material:** S355J2.

**Finish:** Galvanized.

**Note:** Also available with ball-bearing, for higher load.

## Wire Rope Sheave, type SR

### Blueprint

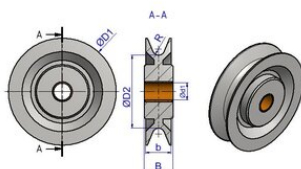

### Technical data

Part code	Rope Ø range mm	Bearing	Type	Max. load ton	D1 mm	D2 mm	R mm	d1 mm	B mm	b mm	Weight kg
140100600120	2-6	-	SR 050 G	0.1	50	38	3,2	10	16	12	0.1
140100800120	3-8	-	SR 075 G	0.2	75	59	4,2	12	20	18	0.3
140100900120	4-9	-	SR 100 G	0.3	100	80	4,8	16	25	21	0.6
140101000121	6-10	Bronze bearing	SR 125 G	0.5	125	103	5,3	16	25	21	0.9
140101000125	6-10	Bronze bearing	SR 200 G	1.5	200	166	5,3	30	38	32	4.5
140101200121	8-12	Bronze bearing	SR 150 G	0.75	150	126	6,5	20	25	22	1.4
140101200125	10-12	Bronze bearing	SR 250 G	2	250	213	6,5	40	41	36	7.9
140101600120	12-16	-	SR 300 G	4	300	257	8,5	50	62	40	12.8