

## Dee Shackle BigMouth® SC G-4551

### Product information



The Green Pin BigMouth® Dee Shackle SC is ideal for use in situations where a lifting point is out of reach for a standard shackle. The BigMouth® Dee Shackle SC has a wider inside width and a longer inside length enabling you to connect the shackle to non-typical lifting points. Such lifting points are for example often found in the steel sheet pile wall industry. The lifting points on the pile walls are usually set at a depth at which only a Green Pin BigMouth® Dee Shackle SC can be used to complete the job. The Green Pin BigMouth® Dee Shackle SC is fitted with a screw collar pin. Long-term durability is assured due to the galvanization of the Green Pin BigMouth® Dee Shackle SC. The shackle conforms to a range of certifications. The Green Pin BigMouth® Dee Shackle SC is suitable for both one-leg and multi-leg systems and is available in a range with a working load limit from 4.6 up to 15.5 ton.

#### Features:

- Longer inside length and wider inside width
- Perfect for lifting steel sheet pile walls
- Galvanization assures long-term durability
- Screw pin for quick (dis)assembly
- Suitable for both single-leg and multi-leg systems

Certification on request: 2.1, 2.2, 3.1, MTCa

[... Read more](#)

**Material:** Bow and pin alloy steel, quenched and tempered

**Marking:** CE-marked, Pin: Country, Brand (GP), grade (8), and traceability code.

Bow: Country, Brand (GP), grade (8), traceability code, WLL and size

**Temperature range:** -20°C up to +200°C

**Finish:** Hot dipped galvanized

**Safety factor:** 5:1

**Grade:** 8

## Dee Shackle BigMouth® SC G-4551

### Blueprint

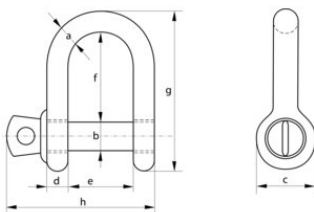

### Technical data

Part code	WLL ton	Size	a mm	b mm	c mm	d mm	e mm	f mm	g mm	h mm	Weight kg
420100322840	3.2	16	16	19	39	16	58	102	148	120	0.85
420100462840	4.6	19	19	22	46	19	70	116	170	142	1.36
420100862840	8.6	25	25	28	59	25	83	140	209	177	2.83
420101272840	12.7	32	32	35	73	32	99	158	246	218	5.46
420101552840	15.5	38	38	42	88	38	115	178	283	258	9.06
420102272840	22.7	45	45	50	104	45	134	204	328	307	14.9