

Open Spelter Sockets with pin OSS P

Product information



Quenched and tempered cast steel range steel wire rope sockets for embedment with cast compound with mechanical values (Charpy-V > 42 Joule /-20°C) for tough and low temperature use. For wire rope diameter 6 - 203 mm (1/4" - 8").

2 surface finishes available:

- Model OSS P: blue painted. (OSS 196 until OSS 100 only Hot dipped galvanized)
- Model OSS P.GAL: Hot dipped galvanized.

Features:

- Pin securing by cotter pin.
- All spelter sockets have a 100% efficiency.
- Also available with pin + bolt (type OSS B)

... [Read more](#)

Material: Quenched and tempered cast steel

Marking: CE-marked, Size, wire rope diameter and batch or serial number.

Temperature range: From - 40°C up to +110°C - 100% capacity range.

Finish: OSS P: blue painted - OSS PGAL : Hot dipped galvanized.

Note: For intermediate rope diameter select fittings with nearest following size.

Warning: Compare the spelter's and the wire rope's minimum breaking load.

Open Spelter Sockets with pin OSS P

Blueprint

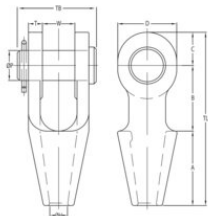

Technical data

| Part code | Code | Rope Ø range mm | MBL ton | Finish | Strand Ø mm | A mm | B mm | C mm | D mm | Ø H mm | Ø P mm | T mm | TL mm | TB mm | W mm | Weight kg |
|--------------|-------------|-----------------|---------|------------|-------------|------|------|------|------|--------|--------|------|-------|-------|------|-----------|
| 122101000242 | OSS197P.GAL | 8-10 | 12 | Galvanized | - | 57 | 45 | 22 | 42 | 13 | 20 | 11 | 124 | 63 | 21 | 0.7 |
| 122101300242 | OSS198P.GAL | 11-13 | 20 | Galvanized | - | 64 | 51 | 27 | 50 | 15 | 25 | 12 | 142 | 67 | 25 | 1 |
| 122101900242 | OSS100P.GAL | 18-19 | 40 | Galvanized | 14-16 | 89 | 76 | 40 | 70 | 22 | 35 | 16 | 205 | 95 | 38 | 3 |
| 122102200242 | OSS104P.GAL | 20-22 | 55 | Galvanized | 18-19 | 101 | 89 | 45 | 80 | 25 | 41 | 19 | 235 | 110 | 44 | 4.6 |
| 122102600242 | OSS108P.GAL | 23-26 | 75 | Galvanized | 20-22 | 114 | 101 | 60 | 104 | 29 | 51 | 22 | 275 | 128 | 51 | 8 |
| 122103000242 | OSS111P.GAL | 27-30 | 90 | Galvanized | 23-26 | 127 | 114 | 65 | 114 | 33 | 57 | 25 | 306 | 142 | 57 | 11 |
| 122103600242 | OSS115P.GAL | 31-36 | 125 | Galvanized | 27-28 | 139 | 127 | 72 | 126 | 39 | 63 | 28 | 338 | 155 | 63 | 15 |
| 122103900242 | OSS118P.GAL | 37-39 | 150 | Galvanized | 30-32 | 152 | 162 | 80 | 142 | 42 | 70 | 30 | 394 | 177 | 76 | 22 |
| 122105400242 | OSS128P.GAL | 49-54 | 280 | Galvanized | 42-45 | 216 | 228 | 108 | 194 | 59 | 95 | 45 | 552 | 244 | 101 | 60 |
| 122107500245 | OSS135P | 69-75 | 460 | Painted | 56-62 | 279 | 279 | 138 | 240 | 81 | 127 | 73 | 696 | 335 | 133 | 155 |
| 122111500245 | OSS146P | 108-115 | 1,200 | Painted | 98-110 | 450 | 480 | 215 | 400 | 129 | 195 | 100 | 1,145 | 465 | 205 | 539 |