

Shackle BN Green Pin Power Sling® P-6043

Product information



The Green Pin Power Sling® Shackle BN is specially developed for heavy lifting. It is the top product in the Green Pin® shackle assortment and the wider lifting industry. The Green Pin Power Sling® Shackle BN has a bending efficiency of 85%. Its shackle crown is the widest in the industry (10% more than shackles of the previous generation) and has an optimal D/d ratio. Furthermore, the areas of the Power Sling® shackle that endure the highest stress have been reinforced. As a result, the Power Sling® lets you save up to 20% on synthetic- and wire rope costs. The long-term performance of the Power Sling® has been scrutinized with tensile- and fatigue testing, subjecting it to more than 40.000 cycles (the API norm specifies 20.000 cycles). Each shackle is proofload tested to twice the working load limit. Ductility of the steel has also been checked at temperatures as low as minus 40 °Celsius degree (-40 °F). Safety and efficiency for riggers are other key benefits of the Power Sling®. The Power Sling® is equipped with six handling points to the body and several more on the pin (larger sizes have more handling points than smaller sizes). Many such handling points are smaller shackles that are attached to the main shackle. Lifting the Power Sling® into place becomes a much safer and easier activity as a result. The Green Pin Power Sling® Shackle BN is available in a range with a working load limit from 125 to 1550T.

Certification on request: 2.1, 2.2, 3.1, MTCb, LROS, MPIb, USb, DNVGL-ST-0378, DNV-GL-ST-0377

... [Read more](#)

Material: Bow and pin alloy steel, quenched and tempered

Marking: CE-marked

Temperature range: -40°C up to +200°C

Finish: Shackle bow painted silver, pin painted green

Safety factor: 5:1

Grade: 8

Shackle BN Green Pin Power Sling® P-6043

Blueprint

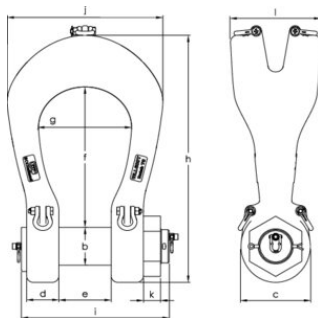

Technical data

Part code	WLL ton	b mm	c mm	d mm	e mm	f mm	g mm	h mm	i mm	j mm	k mm	l mm	Weight kg
420112500960	125	80	166	85	134	364	220	631	382	370	36	205	95
420115000960	150	95	182	90	144	389	250	703	408	420	42	248	134
420120000960	200	105	204	100	154	479	276	838	446	475	47	290	195
420125000960	250	120	238	110	174	539	300	938	503	515	60	314	271
420130000960	300	134	260	121	189	599	350	1.031	550	605	60	345	368
420140000960	400	160	305	140	224	620	370	1.078	645	652	80	392	563
420150000960	500	180	340	152	255	679	450	1.239	714	763	85	440	786
420160000960	600	200	365	170	280	739	490	1.353	788	820	90	475	1.009
420112500961	1,250	300	470	245	442	928	650	1,812	1,164	1,144	140	670	2.933