

Bow Shackle BN Green Pin BigMouth® G-4263

Product information

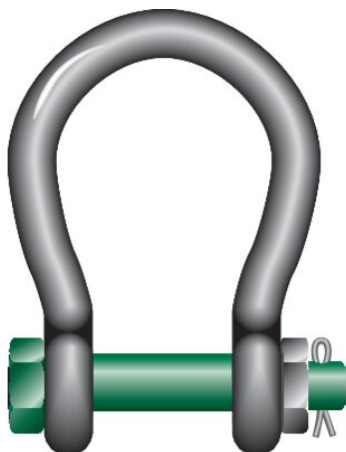

The Green Pin BigMouth® Bow Shackle BN is a grade 8 shackle with a safety bolt and a wider shackle mouth. The wider shackle mouth enables you to connect the shackle to a connecting point (e.g. a pad eye) which is wider than usual. The shackle also offers a double safety (split pin and safety bolt) which prevents accidental unscrewing of the pin. Long-term durability is assured due to the galvanization of the Green Pin BigMouth® Bow Shackle BN. Of course, the Green Pin BigMouth® Bow Shackle BN conforms to a range of certifications. The shackle is suitable for both one-leg and multi-leg systems and is available in a range with a working load limit from 4.75 up to 75 ton.

Certification on request: 2.1, 2.2, 3.1, MTCa

[... Read more](#)

Material: Bow and pin alloy steel, quenched and tempered

Marking: CE-marked

Temperature range: -20°C up to +200°C

Finish: Hot dip galvanized

Safety factor: 6:1

Grade: 8

Bow Shackle BN Green Pin BigMouth® G-4263

Blueprint

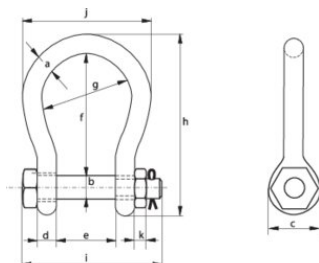

Technical data

Part code	WLL ton	A mm	B mm	C mm	D mm	e mm	f mm	g mm	h mm	i mm	j mm	k mm	Weight kg
420100481020	4.75	22	25	52	22	63	112	88	173	157	132	23	2.08
420100651020	6.5	25	28	59	25	75	135	105	204	183	155	25	3.14
420100851020	8.5	28	32	66	28	82	148	115	225	205	171	27	4.36
420100951020	9.5	32	35	72	32	90	162	126	248	224	190	30	5.95
420101201020	12	35	38	79	35	100	180	140	274	245	210	33	7.87
420101601020	16	38	42	88	38	106	216	159	319	248	235	19	12.5
420102501020	25	45	50	103	45	127	248	175	370	296	265	23	16.7
420103001020	30	50	57	118	50	146	273	207	411	332	307	26	25
420105501020	55	65	70	145	65	165	314	213	487	391	343	32	45
420107501020	75	83	83	164	83	184	330	254	537	460	420	39	70