

Ring Clutch Starcon

Product information

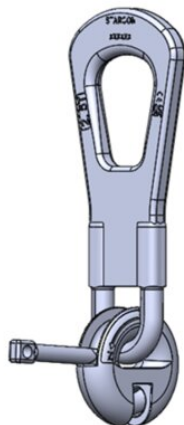

The Starcon ring clutch is a specially designed component with a bolt-shaped ring that grips the hole of the Starcon STA anchor. It enables quick and secure mounting of the ring coupling to the STA anchors by means of a locking bolt that mechanically locks to the anchor.

The ring coupling can be easily connected to a sling or hook, making lifting both fast and safe. It is ideal for use with lifting equipment and cranes, ensuring efficient and reliable handling of concrete elements.

Areas of application: The Starcon ring clutch is used for lifting Starcon STA anchors

Advantages: Ensures handling of concrete elements.

Enables safe lifting in all directions.

Quick and easy installation.

Load group: 2.5t – 10t

Technical information: CE marking according to MD 2006/42 EF

Starcon product is designed according to EN13155-2009 and follows the guidelines of VDI/BV-BS 6205 and DS/CEN/TR 15728. [... Read more](#)

Marking: CE-marked, batch code, load group + S(Starcon)

Finish: Electro-galvanized - Corrosion class C3 - ISO 12944-2.

Note: The delivery time for the individual products is estimated and if the desired quantity is not in stock, please contact [CERTEX Danmark A/S – Starcon](#) for information on the applicable delivery time.

Ring Clutch Starcon

Blueprint

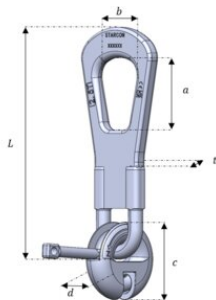

Technical data

Part code	Load grp. t	a mm	b mm	c mm	d mm	t mm	L mm	Weight kg	Packing Qty.
650290025001	2.5	70	54	79	27	12.5	223	0.95	1
650290050001	5	85	59.5	107	37	17	281	1.5	1
650290100001	10	110	82.5	148	50	25	352	3.18	1