

## STA-S Spread Anchor Starcon

### Product information

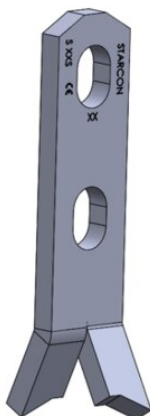

Starcon STA-S, also known as spread anchor, has feet that spread and provide increased strength during the lifting operation, as part of the load is absorbed into the feet. The anchor head has a hole for attaching a ring coupling. The versatile split anchor is equipped with an additional hole for placing additional reinforcement, making it usable for many applications in both thin panels and large surface plates.

For special applications and very thin walls, it can also act as a two-hole anchor with extra holes for extra reinforcement. The STA-S split anchor can be used without additional reinforcement but has the option of installing additional reinforcement if necessary, making it highly flexible and applicable to many different types of precast concrete elements.

**Areas of application:** Walls, beams, thin elements and columns

**Advantages:** Versatile lifting options for different elements.

Ensures optimal lifting performance.

Quick connection/disconnection with shapes and Starcon ring coupling, perfect for efficient transport and setup.

**Load group:** 1.4t – 22t

**Technical information:** CE marking according to MD 2006/42 EF

Starcon product is designed according to EN13155-2009 and follows the guidelines of VDI/BV-BS 6205 and DS/CEN/TR 15728.

**EPD:** Our Environmental Product Declarations (EPDs) are available in the LCA NO calculator/software. These EPDs have been prepared in strict accordance with ISO 14025 and EN 15804 standards.

**Download the EPDs from the LCA database:**

Untreated Products: [Starcon Lifting and Handling Systems for Concrete elements - Untreated - EPD Norge](#)

Surface treated Products: [Starcon Lifting and Handling Systems for Concrete elements - Surface Treated. - EPD Norge](#)

... [Read more](#)

**Marking:** CE-marked, batch code, load group + S(Starcon)

**Finish:** Untreated - Corrosion class C1 - ISO 12944-2. Hot-dip galvanized - Corrosion class C3 - ISO 12944-2

**Note:** The delivery time for the individual products is estimated and if the desired quantity is not in stock, please contact [CERTEX Danmark A/S – Starcon](#) to get information about the applicable delivery time.

## STA-S Spread Anchor Starcon

### Blueprint

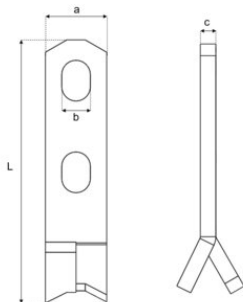

### Technical data

Part code	Load grp. t	Length mm	Finish	L mm	a mm	b mm mm	c mm	Hole mm mm	Weight kg	Packing Qty.
65012202501501	2.5	150	Untreated	150	30	14	10	14x20	0.32	50
65012202501502	2.5	150	Hot dip galvanized	150	30	14	10	14x20	0.32	50
65012202502001	2.5	200	Untreated	200	30	14	10	14x20	0.42	35
65012205001801	5	180	Untreated	180	40	20	15	20x22	0.75	20
65012205001802	5	180	Hot dip galvanized	180	40	20	15	20x22	0.78	20
65012205002401	5	240	Untreated	240	40	20	15	20x22	1.01	15
65012205002402	5	240	Hot dip galvanized	240	40	20	15	20x22	1.05	15
65012207502601	7.5	260	Untreated	260	60	26	16	26x30	1.68	1
65012207502602	7.5	260	Hot dip galvanized	260	60	26	16	26x30	1.8	1
65012210003001	10	300	Untreated	300	60	28	20	28x30	2.65	1
65012210003002	10	300	Hot dip galvanized	300	60	28	20	28x30	2.65	1
65012214003701	14	370	Untreated	370	80	35	20	35x46	3.99	1
65012214003702	14	370	Hot dip galvanized	370	80	35	20	35x46	3.99	1
65012222005001	22	500	Untreated	500	90	35	28	35x46	8.12	1
65012222005002	22	500	Hot dip galvanized	500	90	35	28	35x46	8.16	1