

## Lifting Socket with Cross-hole Starcon

### Product information



The Starcon cross-hole transport anchor is designed with an internal thread for transporting and fastening concrete elements. The transport anchor is always used in conjunction with additional reinforcement, which is bent and installed in the lower cross hole.

The cross-hole transport anchor is available in both metric and circular threads, making it easy to attach wire rope straps and threaded lifting gear products by screwing them onto the transport anchor. This construction gives the small anchor a high lifting capacity and ensures a reliable connection to the wire rope strap.

**Areas of application:** Concrete elements, beams or columns.

**Advantages:** low weight

**Load group:** 0.4t – 4t

**Technical information:** CE marking according to MD 2006/42 EF  
 Starcon product is designed according to EN13155-2009 and follows the guidelines of VDI/BV-BS 6205 and DS/CEN/TR 15728.

**EPD:** Our Environmental Product Declarations (EPDs) are available in the LCA NO calculator/software. These EPDs have been prepared in strict accordance with ISO 14025 and EN 15804 standards.

**Download the EPDs from the LCA database:**

Untreated Products: [Starcon Lifting and Handling Systems for Concrete elements - Untreated - EPD Norge](#)

Surface treated Products: [Starcon Lifting and Handling Systems for Concrete elements - Surface Treated. - EPD Norge](#)

... [Read more](#)

**Marking:** CE-marked, Thread size, batch code, load group + S(Starcon)

**Finish:** Electro-galvanized - Corrosion class C3 - ISO 12944-2.

**Safety factor:** 3:1

**Note:** The delivery time for the individual products is estimated and if the desired quantity is not in stock, please contact [CERTEX Danmark A/S – Starcon](#) for information on the applicable delivery time.

## Lifting Socket with Cross-hole Starcon

### Blueprint

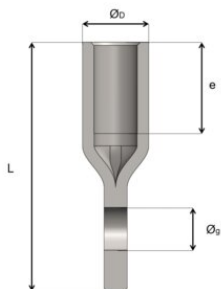

### Technical data

Part code	Thread mm	Load grp. t	Length mm	L mm	Ø D mm	e mm	Øg mm mm	Thread mm mm	Weight kg	Packing Qty.
650530NK3010ZN	M10	0.4	50	50	13.5	22	10	M10	0.031	400
650530NK3012ZN	M12	0.5	60	60	15	25	10	M12	0.041	250
650530NK3016ZN	M16	1.2	79	79	21	32	13	M16	0.1	100
650530NK3020ZN	M20	2	99	99	27.5	37	15	M20	0.22	60
650530NK3024ZN	M24	2.5	110	110	31	40	18	M24	0.28	40
650530NK3030ZN	M30	4	156	156	39.5	56	20	M30	0.688	20